

# VERSACAP

Made with your **ACTUAL FLOORING** for a **PERFECT MATCH** that is **ALWAYS FLUSH!**



Call Toll Free:

**1.866.200.8132**



**Easy Online  
Ordering**

**Versatrim.com**



**VERSATRIM**<sup>®</sup>  
The Leading Molding Brand in North America

**#1 Source for Stair Solutions**  
**Everything But the Floor!**

# ABOUT US

## The Leading Molding Brand in North America!

Versatrim is an award-winning leader in the flooring industry, located outside of Raleigh, NC., that manufactures, sells, and distributes a complete line of custom coordinated floor moldings and trims for laminate and vinyl flooring.

Our innovative approach to molding solutions, and its ability to coordinate with most of the top colors in the vinyl, luxury vinyl tile, wood plastic vinyl, and laminate flooring industry, has guided us to the forefront as a leading manufacturer of floor moldings.

In addition to our core products, we have unique offerings that include flexible moldings, stair solutions, adhesive and a variety of accessories to help complete your flooring projects.

We've proudly been serving our customers for over 25 years. For additional information on our products and services please visit [www.versatrim.com](http://www.versatrim.com).

### TABLE OF CONTENTS

About Us.....	1
How to Order.....	2
VersaCap (Matching Stair Solutions).....	3
Accessories/Hardware .....	4
Brands/ Warranty.....	5
Order Form.....	7
Marketing Resources.....	8
Installation/Application.....	9
Additional Stair Solution Offerings .....	11
White Stair Risers.....	12
Shipping Information.....	13
Pricing.....	14



versatrim.com





Order online at [versatrim.com](http://versatrim.com) or call **1.866.200.8132**

How to Order

HOW TO ORDER

PRODUCTS

BRANDS/WARRANTY

ORDER FORM/MARKETING

INSTALLATION

ADDITIONAL PRODUCTS

SHIPPING/PRICING

## PROGRAM OPTIONS

### Versatrim Provides Floor:

We have partnered with many manufacturers to purchase flooring directly to make VersaCaps. A full list of available brands/collections are listed on pages 5 and 6. The listing is also available online at [versatrim.com](http://versatrim.com).

**Lead Time:** up to 15 business days once order has been released.

### Customer Provides Floor:

Call your Sales Representative to see what brands/collections have been tested: **1.866.200.8132**. If your flooring is not listed, you can send us the floor to test. Please ask your Sales Rep for a testing form. Once a floor has passed testing and is available to produce VersaCaps, the customer is required to ship at least 20% or more flooring than the quantity of caps requested. Unused flooring or waste will not be returned.

**Lead Time:** Up to 15 business days once flooring has been received and order has been released.

**Ship Flooring to:** Attn: VersaCap Orders, Versatrim LLC., 101 Eastern Minerals Road, NC 27537. *Please add your Versatrim Sales Order Number to include on shipping label.*

### To Set Up an Account With Versatrim, Please Complete the Following Steps:

- Visit <http://versatrim.com/how-to-order>
- **Complete the 2 forms to establish your credit terms:**
  1. **Credit Application** – We also accept all major credit cards and certified checks in the event that you choose not to have open credit terms with us.
  2. **Company Contact Form** – This form will enable us to correctly identify your company, to expedite your orders and avoid mistakes.

## HOW TO ORDER

### Place Your Order 1 of 4 Ways:



#### Shop Online:

Order Online at [versatrim.com](http://versatrim.com) and register for a business account by selecting the option on the top tool bar and follow the steps.



#### Email:

Go to [versatrim.com/how-to-order](http://versatrim.com/how-to-order), download an order form & email the completed form to [orders@versatrim.com](mailto:orders@versatrim.com).



#### Fax:

Fill out the order form (on page 7) or go to [versatrim.com/how-to-order](http://versatrim.com/how-to-order), download an order form & fax the completed form to **252.430.8801**.



#### Phone:

**Call Us** – Contact Customer Service by calling **1.866.200.8132**, option 2.

### Return Policy:

VersaCaps are made to order and are considered a custom product and are Non-Returnable.

## NEW PRODUCT HIGHLIGHTS

Ask your Sale Representative for additional information!

**10-Inch Saw Blades**  
See Pages 4 & 14



**NEW!**

**White Stair Risers**  
See Pages 4, 12, & 14



**Available NOW!**

**Floor Vents**



**Coming Soon!**

**VersaCap Round**



**Coming Soon!**



VersaCap



# VERSACAP: MATCHING STAIR SOLUTIONS

## Caps Are Made With Your Actual Flooring to Perfectly Match!

The VersaCap is used to create matching, flush stair treads & returns that perfectly match your floor to give your staircase an elegant cohesive look.

VersaCap is available in the following profiles:

- **VersaCap Edge** - The Edge has a low profile height of 1-7/8"
- **VersaCap Square** - The Square a taller profile height of 2-3/8"
- **VersaCap Round** - A round profile is coming soon!

**Order your flooring plank to complete your tread!** Available with a cap purchase only and will be cut to the size of the cap.

**Lead Time:** Approximately 15 business days

**1 Piece Minimum per order**

**VersaCaps are made-to-order: Once an order is placed it cannot be canceled and the product cannot be returned.**



### VersaCap Edge

Like the VersaCap Square, our VersaCap Edge is made from the actual floor but offers a slimmer profile at 1-7/8" height.

**Length:** 32-46" Long

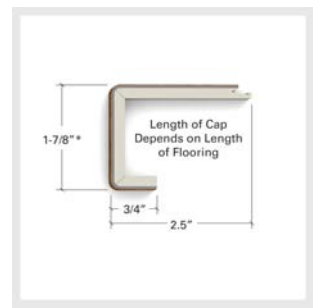

### VersaCap Square

The VersaCap Square is used to create matching, flush stair treads & returns that perfectly match your floor to give your staircase an elegant cohesive look.

**Length:** 32-46" Long

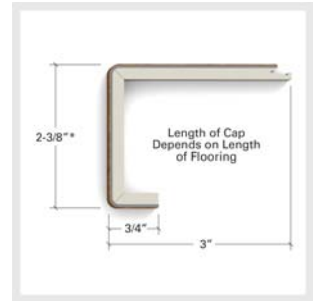

### VersaCap Round

Like the VersaCap Square and Edge, the VersaCap Round is made from the actual floor. It offers an elegant rounded edge to enhance your stair treads.

**Length:** 32-46" Long



### Flooring Plank to Complete Your Tread

If you order a cap in a Versatrim Provided Floor, you can order a flooring plank to complete your stair tread.

**Length:** Cut to the size of your cap

**Flooring plank is only available with a VersaCap purchase! It is not available through the Customer Provides Floor VersaCap program.**

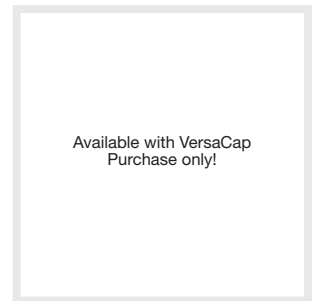

# ACCESSORIES for VersaCap:



## Molding Adhesive by Versatrim

The only molding adhesive you'll need! This wet-set, early-grab, 12-hour curing formula is low-odor and easy-to-clean, leaving no surface residue or ghosting, even once dried. It provides an excellent bond for moldings.

- No Shrink Formula
- High Strength, Waterproof
- Extremely Low VOC
- Covers roughly 15-20 Lin. Ft. depending on application and bead size.
- No Surface Residue
- 12-Hour Cure Time



## 10-Inch Saw Blade

Our high quality 10" Saw Blade is ideal for floor moldings and is designed for ultra smooth cross cutting on a table saw or miter saw. Blade work on all Versatrim products, including VersaCaps & VersaEdge Extra Tall (VEX). **FREE SHIPPING\* on all Saw Blades!**



- Carbide Tipped for long life & smooth cuts
- 80 Teeth Alternate Bevel
- Wide range of use, including aluminum
- Blade can be sharpened
- Heat Resistant Non-Stick Coating for cleaner cuts



## VersaCap Shim

The VersaCap Shim is to be used to install our VersaCap Edge and Square specifically on box staircases, to create a stabilized step.

**Material:** Standard MDF

**Length:** 46" Long

### FOR USE WITH:

- VersaCap Edge
- VersaCap Square



## Bullnose Shim-46

Our Bullnose Shim is to be used to install our VersaCap Round (COMING SOON!), specifically on box staircases, to create a stabilized, rounded step.

**Material:** Standard MDF

**Length:** 46" Long

### FOR USE WITH:

- VersaCap Round



## White TFL Stair Riser

Used to enhance stair landings. Our white stair risers comes in white surface material. No need to paint it white. It is also paintable if you prefer another color.

**Surface Material:** High Quality TFL (Thermally Fused Laminate)

**Core Material:** Standard Particle Board

**Thickness:** Our risers come in 2 thicknesses: 3/8" and 5/8"

**Length:** Comes in 2 lengths: 46" and 96" Long

**46" Risers ship in bundles of 4 or individually with a VersaCap order.**  
**96" Risers are sold by the pallet (min of 100 pcs.) and ship LTL only.**

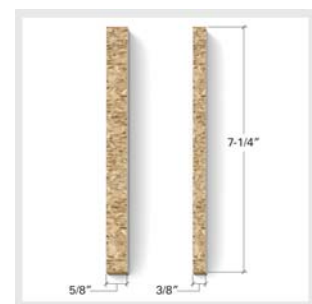

HOW TO ORDER

PRODUCTS

BRANDS/WARRANTY

ORDER FORM/MARKETING

INSTALLATION

ADDITIONAL PRODUCTS

SHIPPING/PRICING

\*Standard Free Shipping

# AVAILABLE FLOORS in the Versatrim Provides Floor Program:

**Versatrim Provides Floor:** We have partnered with many manufacturers to purchase flooring directly to make VersaCaps. A full list of available brands/collections are listed on this 2-page spread. If you don't see your floor listed below, consider our **Customer Provides Floor Program** (See page 2 for details).

**Lead Time:** up to 15 business days once order has been released. See page 2 for details.

BRAND	FLOOR NAME	LENGTH
	Anthem Prime PRO 7 PRO 9 Trio	44" 44" 46" 46" 46"
	Evolution Sawatch	46" 44"
	RigidLock Plus RockLock Plus RockLock Plus II	44" 44" 44"
	Adventure II Bella Sera Brilliance Lifestyle Lux Haus II New Standard II New Standard Plus Renewal	44" 46" 44" 44" 46" 44" 44" 44"
	Fury Ravor SP	44" 44"
	Contract VCC 5mm Runway Vital	44" 46" 44"
	Rigid Hybrid Collection	44"
	Advantage Essential Flex Core Distinctions Flex Core Naturals Rigid Core Values	44" 46" 46" 44" 44"
	H2O (Karndean)	46"
	Blockbuster Plus Black Label/Malibu Black Label/Manhattan Built-Rite Enduring Elegance Extreme Cork Gladiator Maverick Rescue Rustic Elegance/Project X Sidewinder Stone Elegance Thrive	44" 46" 32" 46" 44" 34" 44" 44" 44" 44" 44" 44" 44" 44"
	Foundation Foundation Plus Harbor Pinnacle Sinclair Stonecast 6.5 mm Stonecast 7.0 mm Stonecast 7.5 mm	44" 44" 44" 46" 44" 44" 46" 46"
	Coffee House Farmhouse Manor Public House Sicily Series Skyview	44" 44" 46" 46" 46"

BRAND	FLOOR NAME	LENGTH
	CCA	46"
	K Trade Rigid	44"
	Knight Tile Rigid Core	32"
	Korlok Reserve	44"
	Van Gogh Rigid Core	44"
	PrestG Click	46"
	Carbonado	44"
	Expanse	46"
	Expanse Tile	32"
	Incredible	44"
	Exceptional	44"
	Varacore	44"
	Authentic	46"
	Equity	46"
	Harbor Plank	44"
	Panoramic	46"
	Rigid Click Now/Rigid Plus Timeless	44"
	Beachview Collection	44"
	Cityfield Collection	44"
	Grove Collection	44"
	Oakley Collection	44"
	OceanView Collection	44"
	SeaView Collection	44"
	Timberland Collection	44"
	Urbanite Collection	44"
	Woodlands Collection	44"
	Targhee Collection	44"
	Tenton Collection	44"

Don't see your floor listed? Call **1.866.200.8132** to ask our Versatrim Team about our **Customer Provides Floor Program**. See details below.

## CUSTOMER PROVIDES FLOOR PROGRAM:

**Call our Versatrim Team to see what collections have been tested: 1.866.200.8132**

If your flooring is not listed, you can send us the floor to test. Please ask your Sales Representative for a testing form.

Once a floor has passed testing and is available to produce VersaCaps, the customer is required to ship at least 20% or more flooring than the quantity of caps requested. Unused flooring or waste will not be returned.

To place an order for an available Customer Provides Floor VersaCap, see Page 2 on how to order.

**Lead Time:** Up to 15 business days once flooring has been received and order has been released.

## WARRANTY



Warranties

**We Offer a Limited Lifetime Residential Warranty on Our VersaCaps.**

For more information and to view our warranty, please scan the QR code at the left or go to: [Versatrim.com/warranties](http://Versatrim.com/warranties)



HOW TO ORDER
PRODUCTS
BRANDS/WARRANTY
ORDER FORM/MARKETING
INSTALLATION
ADDITIONAL PRODUCTS
SHIPPING/PRICING







Marketing

Order online at [versatrim.com](http://versatrim.com) or call **1.866.200.8132**

# MARKETING RESOURCES

## VersaCap 6 Inch Sample Piece

Our 6" long VersaCap sample pieces are easy to handle and are available in both Edge and Square. On the bottom of each sample is a label with product specs and dimensions. Our VersaCaps match your floor perfectly, because they are made from the actual flooring.



## VersaCap Handheld Display

Our 7" (w) x 7" (d) x 2.5" (h) Handheld VersaCap Display demonstrates how our VersaCap Square will look installed on a staircase with a return.



If you are interested in receiving a sample,  
Email: [sales@versatrim.com](mailto:sales@versatrim.com)

**Free samples are for flooring businesses only.**

*We don't just sell you the molding, we also help you sell it!*

HOW TO ORDER

PRODUCTS

BRANDS/WARRANTY

ORDER FORM/MARKETING

INSTALLATION

ADDITIONAL PRODUCTS

SHIPPING/PRICING

# BASIC VERSACAP INSTALLATION

**Versatrim does not recommend that you join two caps together in order to complete one stair nose**

**Versatrim does not provide custom cuts**

**CAUTION:** Depending on the floor type, the VersaCap may come with padding. If the padding is not securely attached it should be removed from the cap and/or the plank before installing to stair.

**NOTE:** Small broken areas (less than 1") in the locking system of your Cap will not cause any issues with installation because the cap and floor will be glued down.

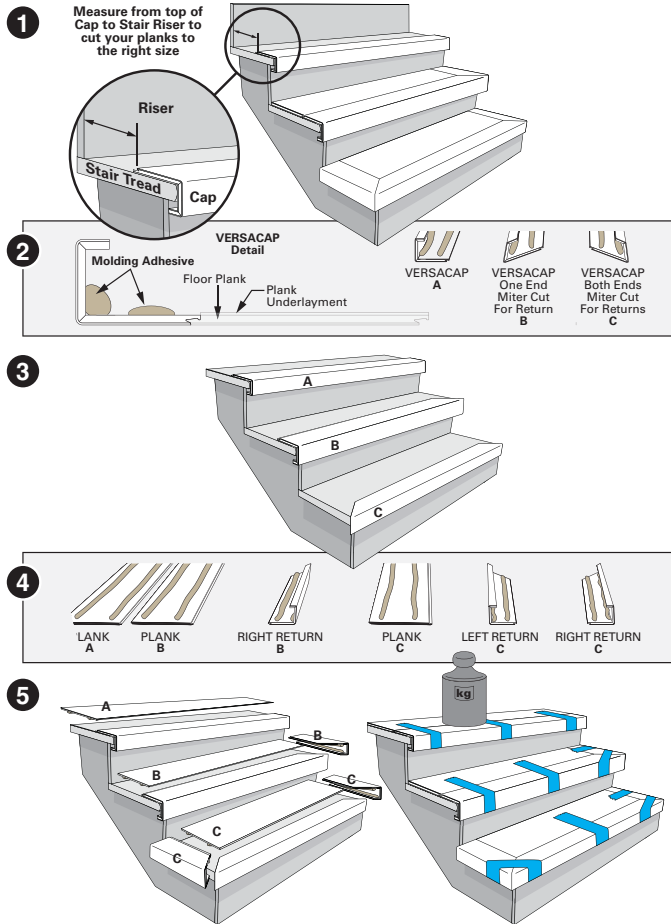

## Step 1

Clean the staircase from all dust and debris. All wood or concrete stair surfaces must be properly prepared, stable, flat, and free of adhesive residue or anything that may be an adhesive bond breaker. **IMPORTANT:** Installing over existing flooring on stairs is not permitted. Existing flooring must be removed.

Once staircase is clean, measure each stair and cut your planks and caps. *If creating returns, use a miter saw set at 45° angles to make the cuts.* Dry fit the caps, returns, & planks prior to spreading any adhesive. Leave them in place until ready to glue down.

**NOTE:** Start at the top of the Stair Case and work your way down. The strategy, as you will see in the steps that follow, will be to glue and staple down the VersaCap first. Then, glue down the plank and/or return(s). Move on to the next stair and repeat Steps 2 to 5.

## Step 2

**IMPORTANT:** The VersaCap does not come with an underlayment. Apply enough adhesive to the broad flat area to make the Caps and Returns level with the floor plank. Turn the first VersaCap over and apply adhesive on the inside corner and a generous amount of Versatrim's Molding Adhesive\* on the broad flat area. (See illustration on the left).

## Step 3

Place the Versacap on the stair. Position it where you want it.

Clean up any excess adhesive with a damp rag.

## Step 4

Make sure the underlayment is firmly and completely attached to the floor plank. If it is not, either remove it or reattach it with PUR adhesive. Next, take the plank and/or return(s) that go with the VersaCap you just fixed on the Stair. Turn them over and apply a generous amount of Molding Adhesive to them. If installing returns, apply glue to the inside corner of the return and then apply adhesive to the broad flat area of the return like you did to the Cap in Step 2. (See illus. at left).

## Step 5

Next, place the plank and/or return(s) in place. Clean up any excess adhesive with a damp rag before applying the painter's tape.

Use painter's tape to tape the VersaCap to the flooring plank and returns. Place a heavy weight across the seams. Let the Molding Adhesive cure for 48 hours before heavy traffic. Once dry, you can remove painter's tape from stairs.

Next, move on to the next stair and repeat Steps 2 to 5.

\* For more information, go to: [versatrim.com/molding-adhesive](http://versatrim.com/molding-adhesive)

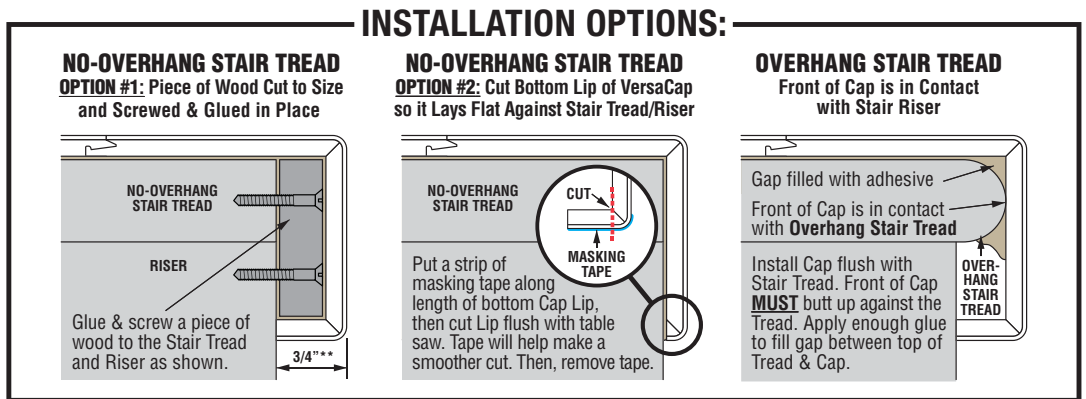
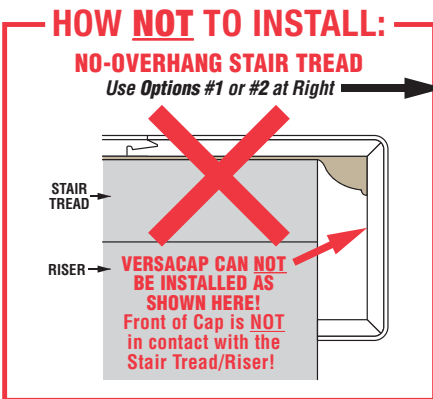

**When we machine the planks we change the symmetry of tension and some bowing is to be expected. Here is how you install a slightly bowed VersaCap:**

- After you cut your planks and VersaCaps to size, dry fit them to see which caps are bowing. You may see a slight 1 to 2 mm gap either towards the ends of the plank or towards the middle caused by the bowing.
- Glue your VersaCap in place on the step. Then apply glue to the back of the plank. We also advise to put a thin swipe of construction glue into the click system of the floor plank.
- Line up the plank to the VersaCap so that both ends meet.
- Start at one end and snap the plank into place by lining it up with the VersaCaps groove and lowering it down.
- Take a strip of painter's tape and start towards the very top of the flooring plank and end under the lip of the VersaCap, or even on the stair riser below the cap, pulling tightly so that the VersaCap and plank are held snug in place by the tape.
- Work your way down to the other end, pressing firmly and using your body weight to push the flooring groove into the VersaCap until it snaps into place.
- Then add strips of painter's tape to the other end and to the center of the tread to hold the VersaCap in place until the glue dries. Apply weights.

\*\*Per 2018 Building code (IBC R311.7.5.3) an overhang stair tread of not less than 3/4" is required when treads are less than 11" deep, but please make sure to check with your local code officials as local jurisdictions have their own rules.

# CUTTING VERSACAP TO CREATE RETURNS

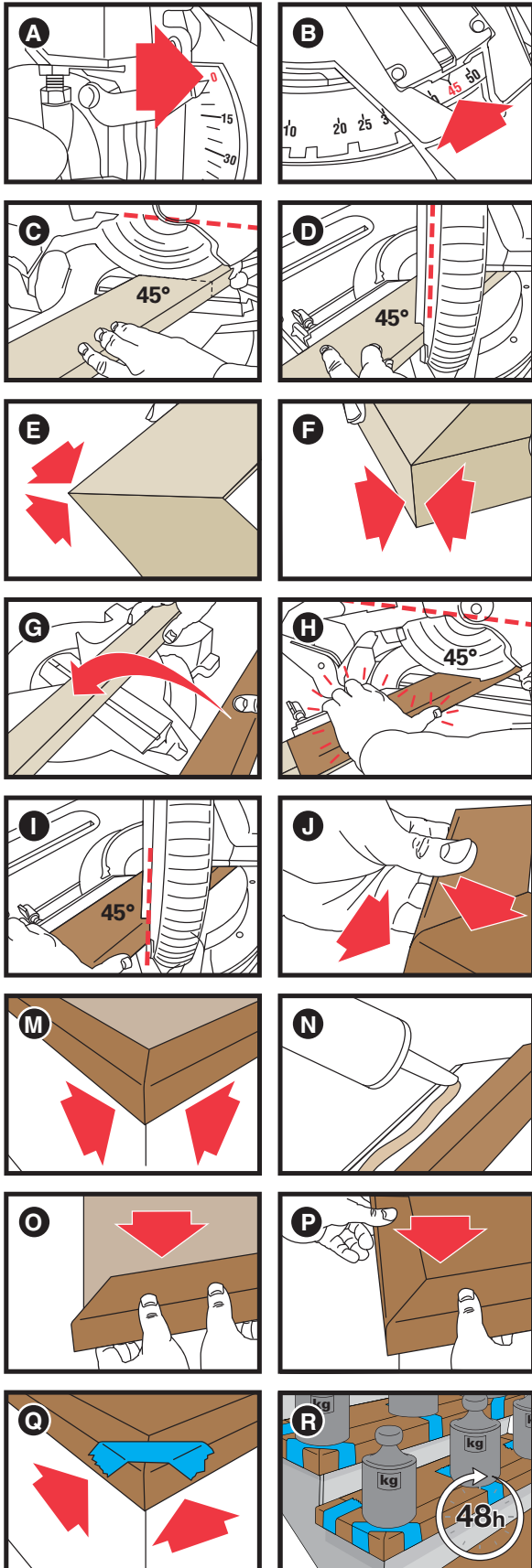

**Versatrim does not provide custom cuts**

**Make sure to use safety goggles and thick gloves while using saw and handling the blade**

## Step 1 – MAKE TEST CUTS ON SCRAP 2x4

**IMPORTANT:** Make sure the bevel angle is set to **ZERO (A)**.

We highly recommend you do a test cut on 2 scrap pieces of 2x4 to make sure your cuts line up. Set the miter angle to **45 degrees** for the first cut (B). Cut the 2x4 (C).

Then change angle of miter cut to **45 degrees** in the other direction (D). Cut the other piece of 2x4.

Line up ends of the 2x4s to form a corner (E). Check the pieces to see if they line up correctly with **no gap** on the top or front view (F).

## Step 2 – CUT YOUR VERSACAP

**IMPORTANT:** Use a scrap 2x4 piece to set VersaCap on while you make the cuts (G). This will keep them level as you cut.

Set the miter angle to **45 degrees**. Cut the VersaCap (H).

**REMINDER:** Always wear safety goggles when using the saw

**IMPORTANT:** Hold the VersaCap extremely tight, otherwise it will pull in the direction of the blade and your cut will be off

Change miter angle to **45 degrees** in the other direction (I). Cut the other piece that you are using for the Return. Again, **make sure you hold the VersaCap extremely tight. Don't let it move while you make the cut.**

Check the Cap & Return to see if they line up correctly with **no gap** on the top or front view (J).

## Step 3 – APPLYING CAP & RETURN TO THE STAIRS

**IMPORTANT:** The VersaCap does not come with an underlayment. Apply enough adhesive to the broad flat area to make the Caps & Returns level with the floor plank.

After wiping the Cap & Return clean from debris, test the fit on your stairway. Make sure there is no gap between them (M).

After you test the fit, run thick lines of **Versatrim's Molding Adhesive\*** along the inside corner and along the broad flat surface of the VersaCap (N).

Put the Cap in place, pressing down firmly to make sure it is in contact with the stair (O). Make sure the edge is square.

**Clean up any excess adhesive with a damp rag.**

**IMPORTANT:** Make sure the underlayment is firmly and completely attached to the floor plank. If it is not, either remove it or reattach it with PUR adhesive.

Next, take the plank and Return that go with the VersaCap you just fixed on the Stair. Turn them over and apply a generous amount of **Molding Adhesive** to them. Apply glue to the inside corner of the return and then apply adhesive to the broad flat area.

Next, place the plank and Return in place (P).

**Clean up any excess adhesive with a damp rag before applying the painters tape.**

While pressing both ends firmly together, stretch a piece of painter's tape tightly across the corner edge to keep the moldings from separating while the adhesive cures (Q).

Place a heavy weight across the seams (R).

Let the Molding Adhesive cure for 48 hours before heavy traffic. Once dry, you can remove painter's tape from stairs.

**\* For more information, go to: [versatrim.com/molding-adhesive](http://versatrim.com/molding-adhesive)**





**Need Help Installing? Go to:**  
[www.versatrim.com/technical-specifications](http://www.versatrim.com/technical-specifications)  
This site is provided as a convenience to our customers for simple Versatrim step-by-step installation instructions as PDFs and easy to follow videos.



HOW TO ORDER
PRODUCTS
BRANDS/WARRANTY
ORDER FORM/MARKETING
INSTALLATION
ADDITIONAL PRODUCTS
SHIPPING/PRICING



**ASK YOUR SALES REP FOR A VERSATRIM MOLDING/TRIM CATALOG!**

**VERSATRIM**  
The Leading Molding Brand in North America

**#1 Source for Stair Solutions!**

## ADDITIONAL STAIR SOLUTIONS

If VersaCap does not fit your needs, Versatrim offers 4 additional stair solution profiles for flush or overlap installs:

- **Round Stair Nose** - Round, PVC Stair Nose with a 1.5" profile height. For use on flooring with an overall thickness of up to 3/4" (19 mm)\*.
- **VersaEdge Stair Nose** - Square, PVC Stair Nose with a 1" profile height. For use on flooring with an overall thickness of up to 3/4" (19 mm)\*.
- **VersaEdge Extra Tall Stair Nose** - Square, aluminum Stair Nose with a 1.5" profile height. For use on flooring with an overall thickness of up to 3/4" (19 mm)\*.
- **Moisture Proof Stair Nose** - 3/4" high, exterior grade composite wood product Stair Nose. For use on 8 mm and 12 mm floors.

Each of the above moldings are:

- Available in thousands of colors to choose from that will coordinate with your floor
- 94" Long
- Waterproof

**1 Piece Minimum per order**

**Round Stair Nose, VersaEdge Extra Tall and Moisture Proof Stair Nose are made-to-order and are nonreturnable.**

*These moldings can **not** be shipped with a VersaCap order. Contact your Sales Representative for more information.*



Stair Solutions



White Risers

Order online at [versatrim.com](http://versatrim.com) or call **1.866.200.8132**

# WHITE STAIR RISERS



## White Stair Risers

Used to enhance stair landings. Our white stair risers comes in high quality TFL cabinet finish that is highly durable, and easy cleanable. No need to paint it white. It is also paintable if you prefer another color.

**Surface Material:** High Quality TFL (Thermally Fused Laminate)

**Core Material:** Standard Particle Board

**Thickness:** Our risers come in 2 thicknesses: 3/8" and 5/8"

**Length:** Comes in 2 lengths: 46" and 96" Long

**46" Risers ship in bundles of 4 or individually with a VersaCap order.**  
**96" Risers are sold by the pallet (min of 100 pcs.) and ship LTL only.**

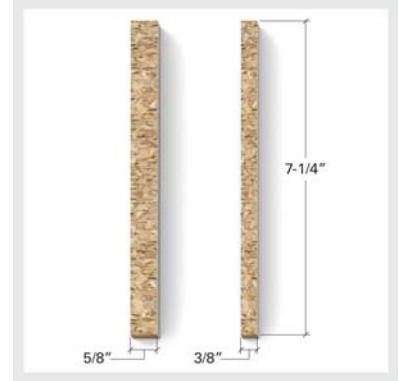

### PRODUCT HIGHLIGHTS:

- Ready to install with a durable TFL white finish
- Lightweight and non-warp particle board core
- Paintable surface\*
- Available as a bundle option for our VersaCap (See details below).

\*Requires a light sanding before painting



## Ask About Our New VersaCap Bundle!

Our **VersaCap Bundle** includes the following:

- 1 VersaCap
- 1 Plank
- 1 Riser\*\*

Other bundle options are also available to help complete your stair project:

- 1 VersaCap & 1 Plank
- 1 VersaCap & 1 Riser\*\*

**Ask a Sales Representative For Additional Details**

\*\*Riser only offered in 3/8 x 46 for bundle. Riser quantity must equal VersaCap quantity ordered. No special cut on Risers.



HOW TO ORDER

PRODUCTS

BRANDS/WARRANTY

ORDER FORM/MARKETING

INSTALLATION

ADDITIONAL PRODUCTS

SHIPPING/PRICING

# FLAT RATE SHIPPING POLICY

Effective March 1, 2024

Please contact our customer service department for shipping charges for Hawaii, Alaska and any location outside the United States of America.



# Transit Time

Transit times reflect **standard business days** which does not include Saturday or Sunday. **Saturday delivery may be available upon request at an additional cost.**

Lead times are for FedEx Ground Shipments. LTL Shipments with trucking companies have a similar transit time, for exact transit times please contact your sales associate.

**Transit may take an additional day or two at times.**

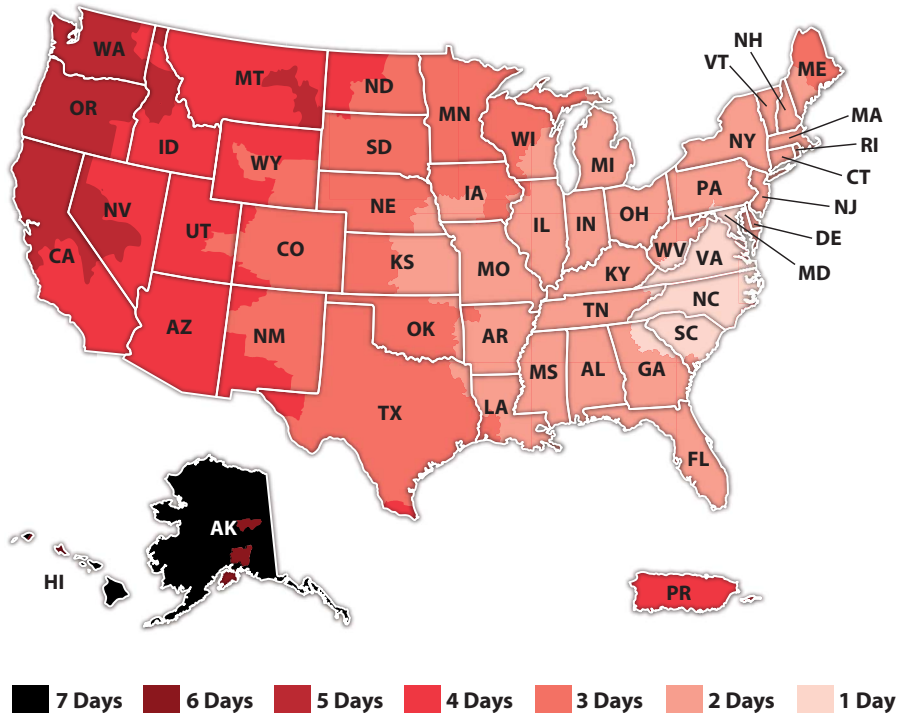

## PRICING

### VersaCap

#### Price List

(FOB Henderson, NC)

		VersaCap	VersaCap Customer Provides the Flooring
<b>Quantities</b>		1 Piece	1 Piece
<b>Lead Time</b>		15 Business Days	15 Business Days
<b>Returns</b>		Custom Product: Non-Returnable	Custom Product: Non-Returnable
<b>VCAP ED</b>		VersaCap Edge	
<b>VCAP SQ</b>		VersaCap Square	
		VersaCap Edge or Square Shim	
		Flooring Plank to be Replaced	NA
<b>VersaCap Bundles</b>		Versacap Edge, Plank, and 3/8 46" Riser	NA
		Versacap Square, Plank, and 3/8 46" Riser	NA
		Versacap Edge and Plank	NA
		Versacap Square and Plank	NA
		Versacap Edge and 3/8 46" Riser	NA
	Versacap Square and 3/8 46" Riser	NA	

**Contact Your  
Sale Representative  
For Pricing!**

**1.866.200.8132**

### White Stair Risers

(FOB Henderson, NC)

	Effective 1/1/24	46" Long	96" Long + Ships LTL Only! Can Not Ship With VersaCap Order
	3/8 Thick TFL Stair Riser		
	5/8 Thick TFL Stair Riser		

### Molding Adhesive

(FOB Henderson, NC)

	Effective 1/1/24	1 Tube	Case of 12 Tubes
	Molding Adhesive****		

\*\*\*\*Ships free with any molding order. \$3.50 per tube. For lower 48 Continental United States Only.

### Saw Blades

(FOB Henderson, NC)

	Effective 3/01/24	1 Blade
	10-Inch Carbide Tipped ATB Saw Blade, 80-Tooth****	

\*\*\*\*Free Standard Shipping for blades.

# EXPERIENCE the Versatrim Difference With Our **NEW ONLINE STORE!**

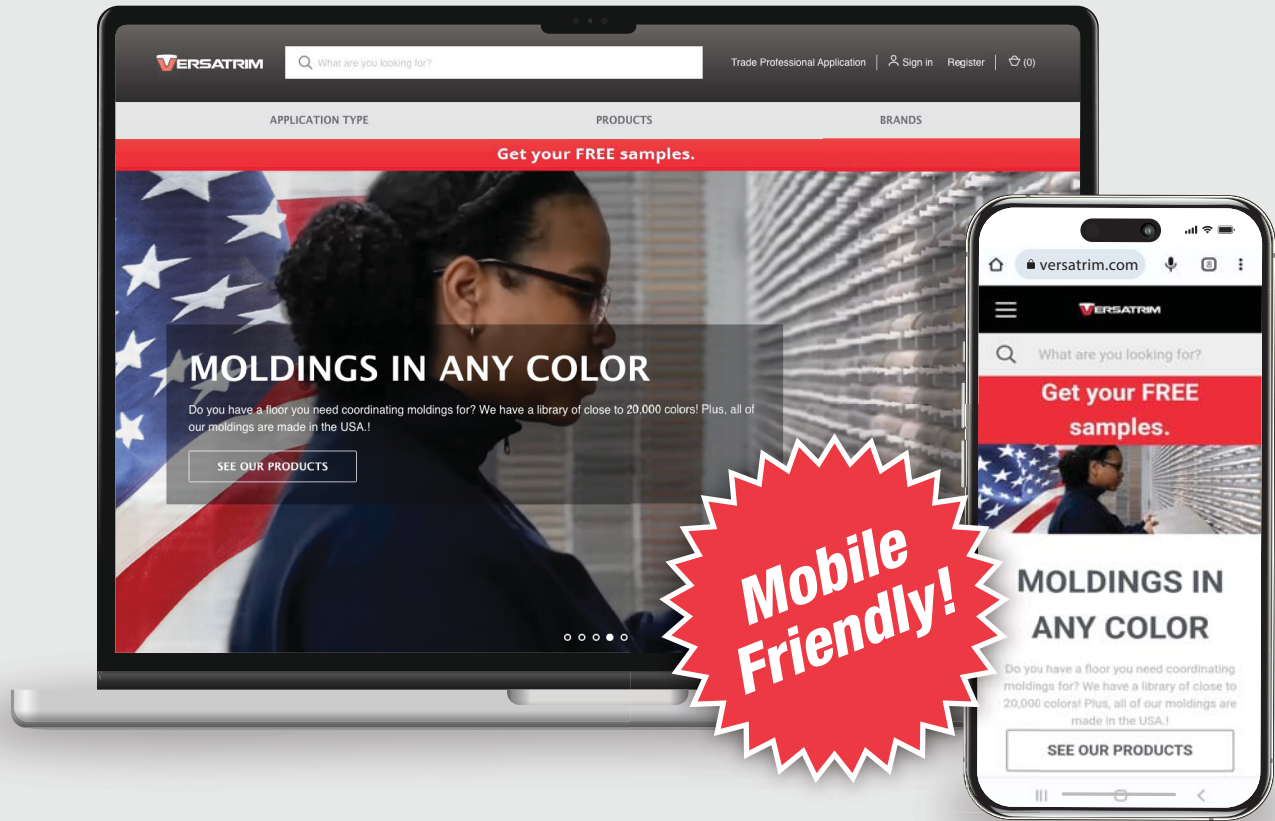

**Quick Ship Items & No Minimums!**

**Versatrim.com**

**SHOP NOW!**



**1.866.200.8132**

Versatrim LLC, 101 Eastern Minerals Road, Henderson, NC 27537 USA • [versatrim.com](http://versatrim.com) • [sales@versatrim.com](mailto:sales@versatrim.com)

Versatrim, an award-winning leader in the flooring industry located just outside Raleigh, NC, distinguishes itself through its comprehensive line of custom-coordinated floor moldings and trims tailored for laminate and vinyl flooring. Versatrim's innovative approach to molding solutions, coupled with its expert coordination with the latest color trends in the vinyl, LVT, WPC, SPC, and laminate flooring sectors, has propelled the company to the forefront as a premier manufacturer of floor moldings and accessories.

Follow Us:



2083-3/24-NP

© 2024 Versatrim, LLC. All rights reserved.

NP